

warranty.tempur.com

BF010056

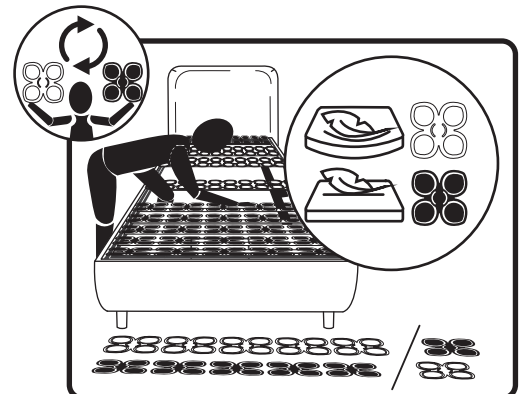

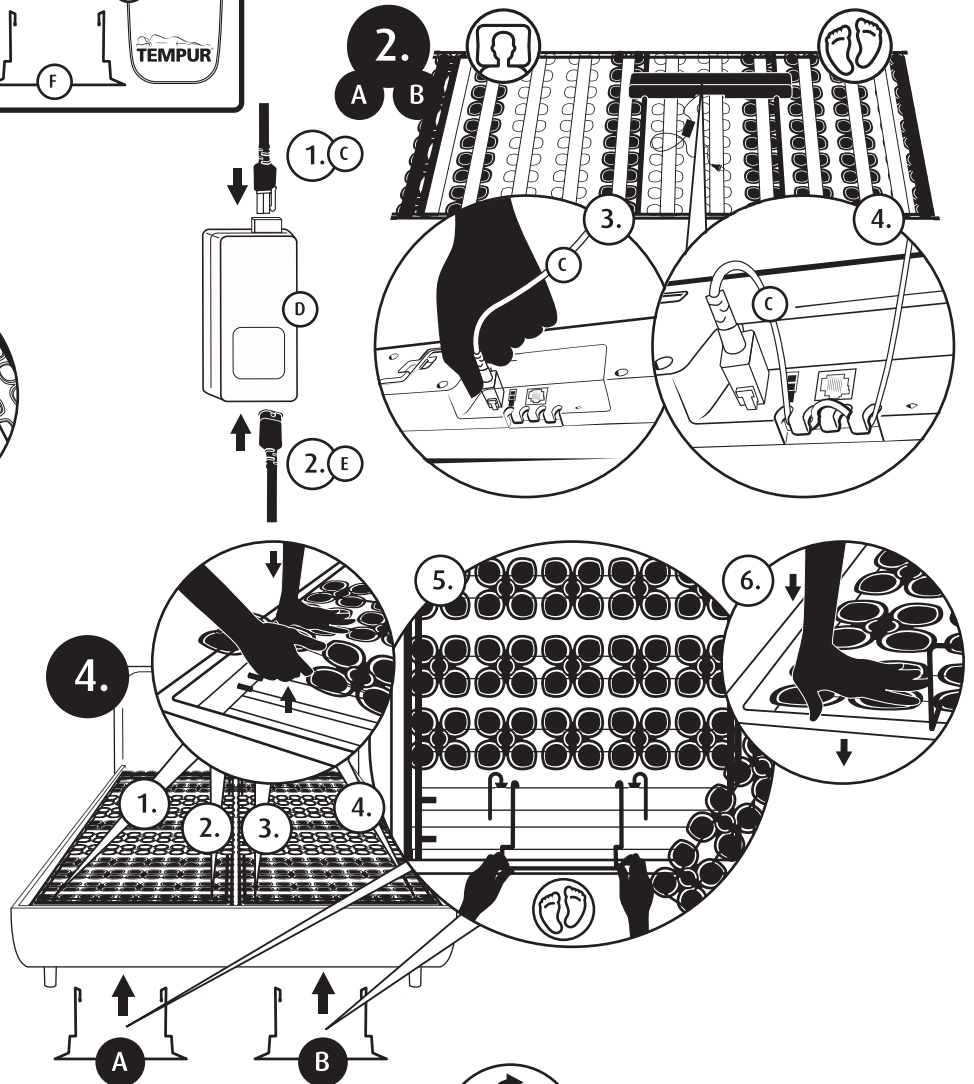

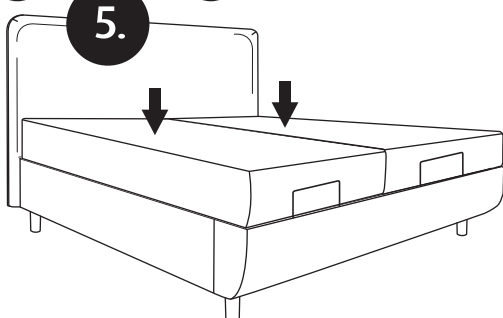
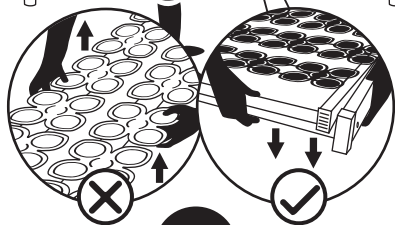
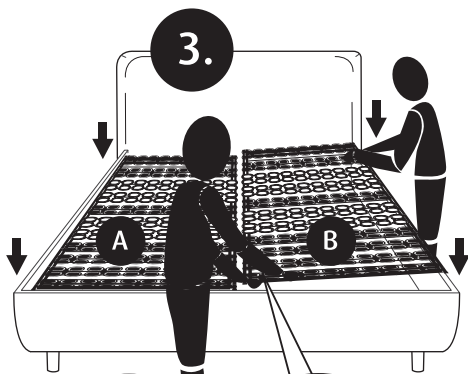
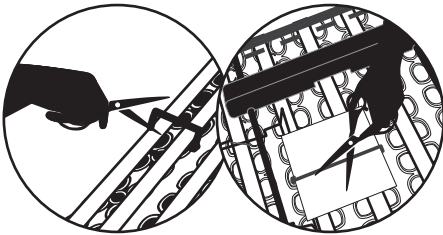
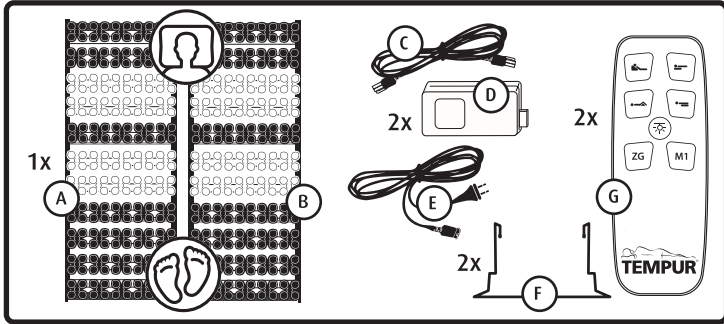
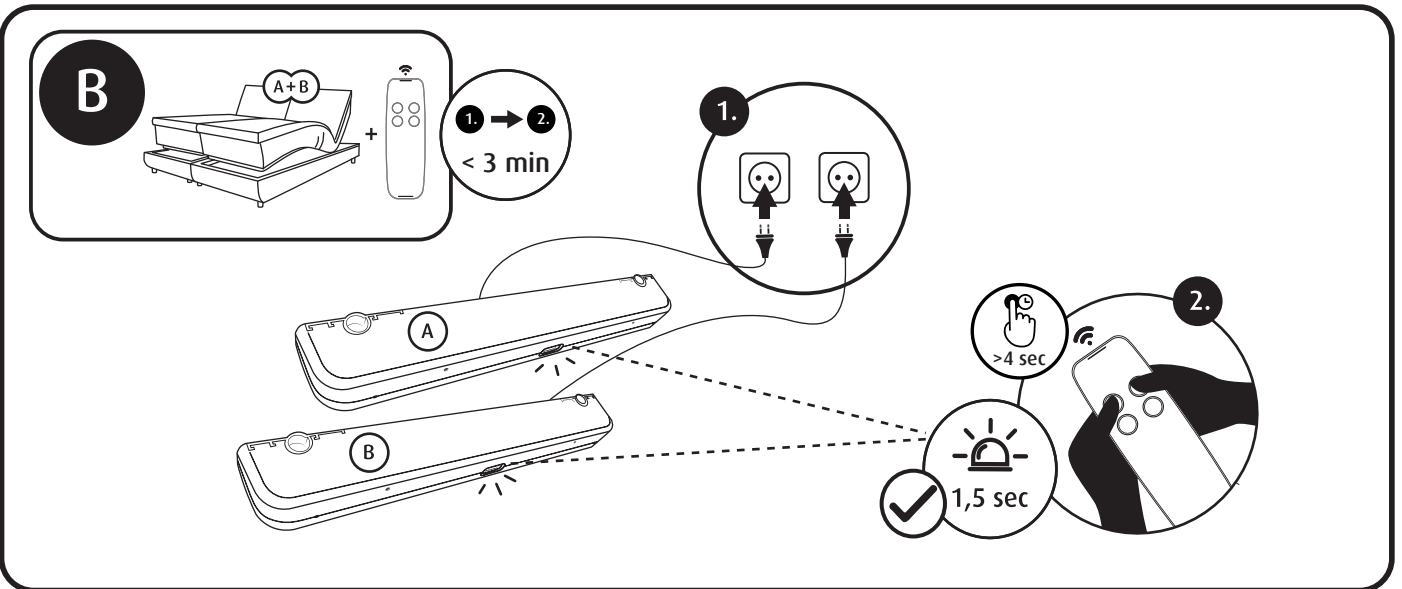
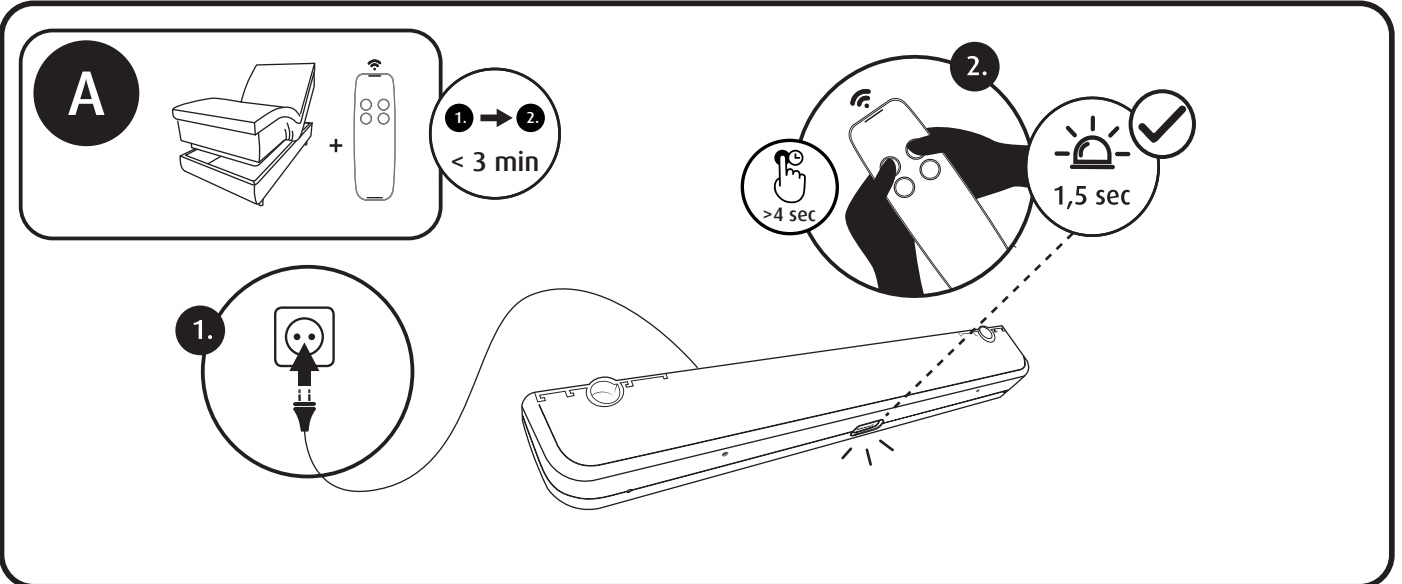
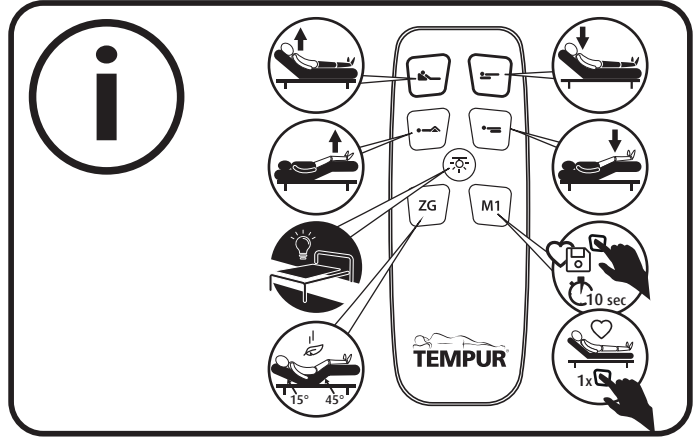
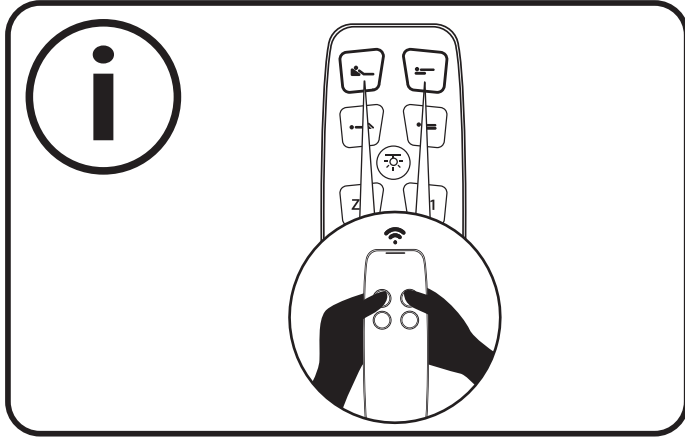
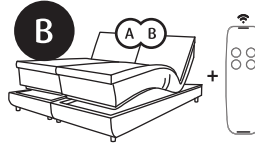
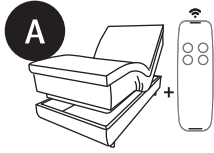
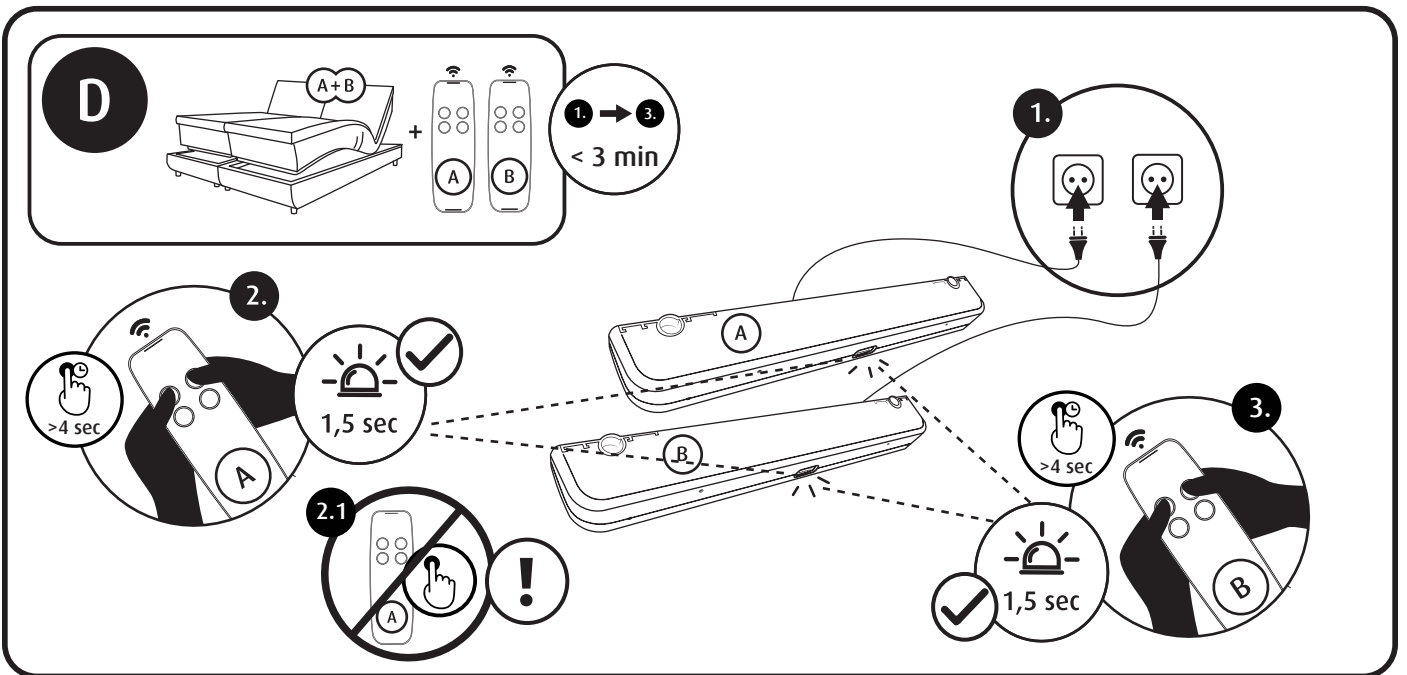
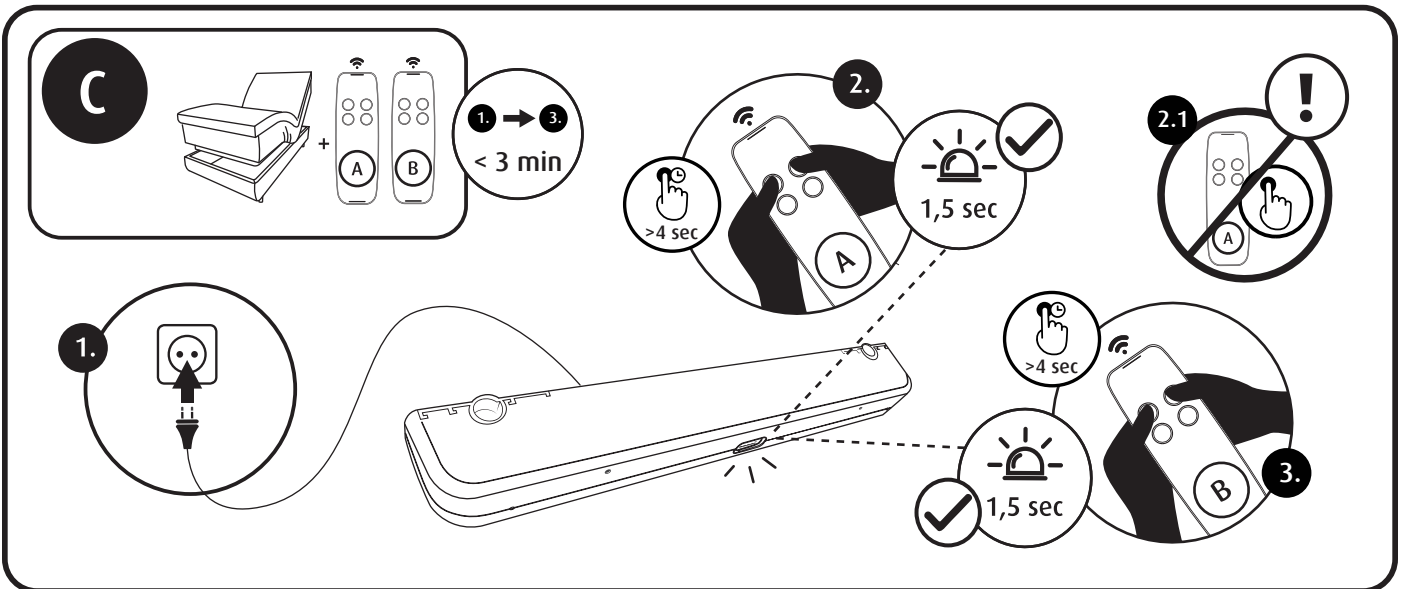
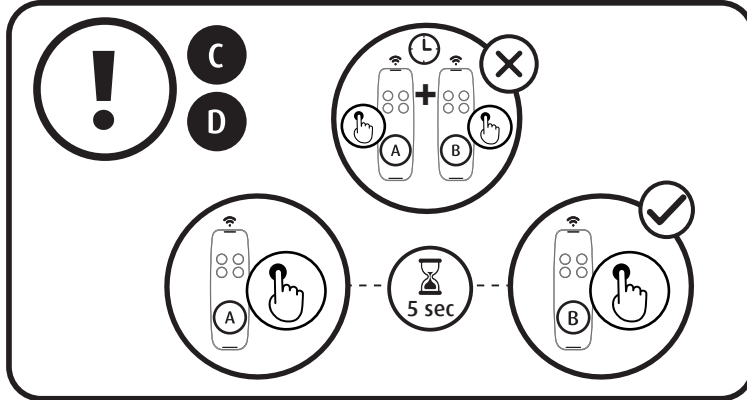
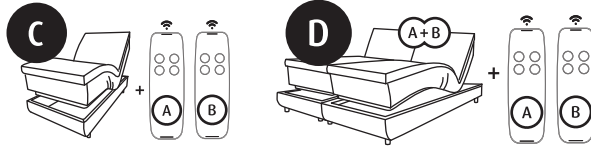

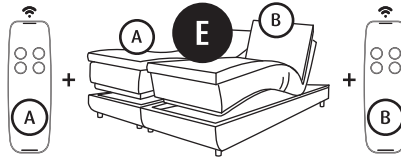

E

1. → 6. < 3 min

1. Plug the power cord into the wall outlet.
2. Press and hold the power button on remote A for >4 sec. A light indicator on the bed will flash for 1,5 sec.
3. Press the power button on remote A.
4. Plug the power cord into the wall outlet.
5. Press and hold the power button on remote B for >4 sec. A light indicator on the bed will flash for 1,5 sec.
6. Press the power button on remote B.

a

1. Plug the power cord into the wall outlet.
2. Wait 1 min.
3. Press buttons A, B, C, D, E in sequence.

b

1. Press the ZG button on the smartphone app.
2. Plug the power cord into the wall outlet.
3. Wait 5 sec.
4. Press buttons A, B, C, D, E in sequence.